



Winners Run RICHMOND!

# Transmissions

## 6-Speed Overdrive - ROD



### Dimensions

The Richmond Six Speed overdrive transmission was designed with the driving enthusiast in mind. The six speed transmission is made in the U.S.A. by American Craftsmen using the latest CNC machining and in house heat treat. Based on our bullet proof five speed design, the Richmond ROD has another gear-to-grab overdrive!

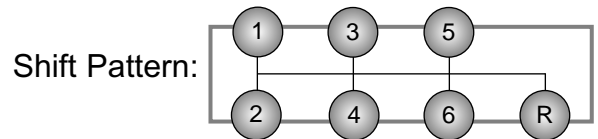
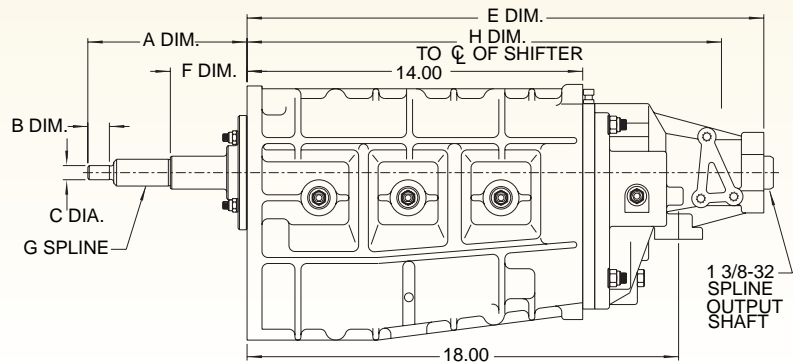
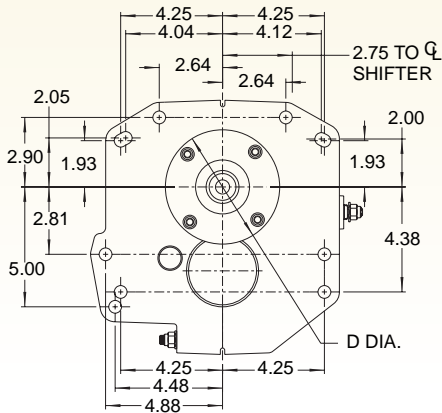

### MOUNTING SPECIFICATION GUIDE

APPLICATION	PART NO.	A DIM.	B DIM.	C DIA.	D DIA.	E DIM.	F DIM.	G SPLINE	H DIM.	J DIM.
Corvette (4)	7071626	6.66	1.06	.590	4.683	23.50	3.22	1-1/8 - 26	22.38	2.63
Ford	7041626	6.49 (1)	1.14 (1)	.668	4.849	24.00	3.83	1-1/8 - 26	20.75	2.00
Ford (7)	7041610	7.18	1.14	.668	4.849	24.00	4.37	1-1/16 - 10	20.75	2.00
Ford T-5 (2)	7081610	7.18	1.14	.668	4.849	24.00	4.37	1-1/16 - 10	20.75	2.00
GM	7021610	6.66	1.06	.590	4.683	21.57	3.22	1-1/8 - 10	20.75	2.00
GM	7021626	6.66	1.06	.590	4.683	21.57	3.22	1-1/8 - 26	20.75	2.00
GM T-5 (5)	7051626	6.66	1.06	.590	4.683	24.00	3.22	1-1/8 - 26	23.25	1.50 (3)
GM Truck (6)	7061610	6.66	1.06	.590	5.124	21.57	3.22	1-1/8 - 10	20.75	2.00
Mopar	7031618	8.57	2.54	.748	4.807	24.00	4.28	1-3/16 - 18	20.75	2.00

- (1) For small block engines. For big block engines, cut pilot (B Dim.) by .38.
- (2) 1984 - 1993 (5.0 L) Includes cross member and speedometer hook-up kit. Bellhousing must be replaced with Lakewood p/n 15202, or equivalent. May also use '79 - '83 Mustang V-8 bellhousing.
- (3) Transmission is mounted on a 17 degree angle.
- (4) Corvette 4 + 3 replacement transmission 1984 - 1988. Includes special tailhousing and shifter for torque arm hook-up.
- (5) "F" body T-5 replacement comes with cross member, speedo cable extension and special shifter for torque arm hook-up.
- (6) Uses 5.124 dia. input bearing retainer, GM truck 1968 - Up.
- (7) '78 - '83 (5.0 L) All transmissions include shifter, back-up light switch and wire harness.

Use RICHMOND Transmission Lube Part # TLUBE (pg 126)

Performance Matched For WINNERS!

Center Distance	3.50 Inches
Oil Capacity	2 U.S Quarts (2-1/2 Quarts = GM T-5 version)
Approximate Dry Weight	108 lbs.
Case & Extension Housing	Aluminum
Controls	Side Lever

Always in stock at your local RICHMOND distributor



Phone: 864-843-9231 • Fax: 864-843-2964 • www.richmondgear.com

### Input Sets & Selection Guide

Aided in design with NASCAR proven technology, the Richmond ROD features smooth, positive and fast shifting. Available in multiple gear ratios, the ROD delivers strong, light weight performance. Overdrive ratios are available from .91 to .52. Engineered with a pro-quality approach, the Richmond ROD delivers the strength and performance you expect!

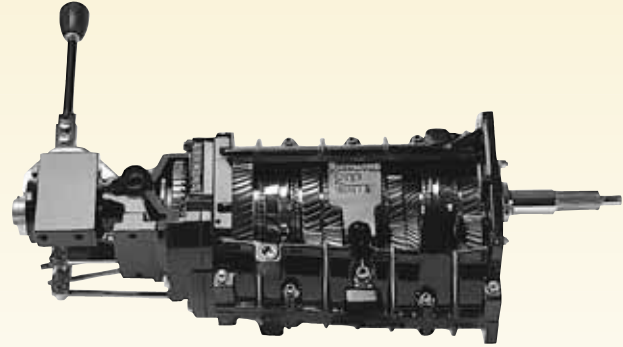

### INPUT SETS

	22T/37T INPUT/CLUSTER	27T/31T INPUT/CLUSTER
GM 1-1/8" 26 Spline	4521826 / 5551837	4522827 / 5522531
GM 1-1/8" 10 Spline	4521810 / 5551837	N/A
Ford 1-1/8" 26 Spline	4541826 / 5551837	N/A
Ford 1-1/16" 10 Spline	4541810 / 5551837	N/A
Mopar 1-3/16" 18 Spline	4531818 / 5551837	N/A

### TRANSMISSION PART NO. DESCRIPTION

Part no. (7 Digits) + Ratio Letter  
 Example 7021610AA  
 GM six speed 10 spline  
 Input 3.28 1st .76 6th

#### 1ST LETTER = 1ST GEAR RATIO

A=3.28	B=4.06
C=4.42	D=3.01
E=2.77	J=3.04
K=2.08	L=2.24

#### 2ND LETTER = 6TH GEAR RATIO

A=.76	B=.81
C=.86	D=.62
E=.91	G=.59
H=.52	I=.55

#### SPECIAL 9 DP ROAD RACE RATIOS

K=.80	L=.84
-------	-------

### TRANSMISSION RATIO SELECTION GUIDE

			MASTER DRIVE SET DRIVE RATIO		22/37	27/31
GEAR	TOOTH COUNT	SET RATIO	MAINSHAFT GEAR	CLUSTER GEAR	RATIO	
1st	42/16	2.625	1071842	1551516	4.41	3.01
	41/17	2.412	1071841	1551517	4.06	2.77
	39/20	1.950	1071839	1551820	3.28	2.24
	38/21	1.810	1022838	1522821	3.04	2.08
2nd & 3rd	36/22	1.636	2322836	2522822	2.75	1.88
	35/24	1.458	2322835	2522824	2.45	1.67
	33/25	1.320	2371833	2551525	2.22	1.52
	33/26	1.269	2371833	2551826	2.13	1.46
	32/27	1.185	2322832	2522827	1.99	1.36
	28/30	0.933	2371528	2551830	1.57	1.07
4th	25/34	0.735	2460025	2560034	1.24	0.84
	30/29	1.034	2460030	2560029	1.74	1.19
5th					1.00	1.00
	24/53	0.453	4112024	5110053	0.76	0.52
	25/52	0.481	4112025	5110052	0.81	0.55
	26/51	0.510	4112026	5110051	0.86	0.59
	27/50	0.540	4112027	5110050	0.91	0.62
6th	25/34	0.735	4112925	5110934	N/A	0.84
	19/40	0.475	4112919	5110940	0.80	N/A





### Replacement Parts

For view number see exploded view on page 47.

#### 1ST GEAR (MAINSHAFT)

VIEW #	PART NO.	DESCRIPTION
1	1071842	42/16 Tooth Count
	1071841	41/17 Tooth Count
	1071839	39/20 Tooth Count
	1022838	38/21 Tooth Count

#### 1ST GEAR (CLUSTERSHAFT)

VIEW #	PART NO.	DESCRIPTION
2	1551516	42/16 Tooth Count
	1551517	41/17 Tooth Count
	1551820	39/20 Tooth Count
	1522821	38/21 Tooth Count

#### 2ND & 3RD GEAR (MAINSHAFT)

VIEW #	PART NO.	DESCRIPTION
3 & 4	2322836	36/22 Tooth Count
	2322835	35/24 Tooth Count
	2371833	33/25 Tooth Count
	2371833	33/26 Tooth Count
	2322832	32/27 Tooth Count
	2371528	28/30 Tooth Count

#### 2ND & 3RD GEAR (CLUSTERSHAFT)

VIEW #	PART NO.	DESCRIPTION
6 & 7	2522822	36/22 Tooth Count
	2522824	35/24 Tooth Count
	2551525	33/25 Tooth Count
	2551826	33/26 Tooth Count
	2522827	32/27 Tooth Count
	2551830	28/30 Tooth Count

#### 4TH GEAR (MAINSHAFT)

VIEW #	PART NO.	DESCRIPTION
5	2460025	34/25 Tooth Count
	2460030	29/30 Tooth Count

#### 4TH GEAR (CLUSTERSHAFT)

VIEW #	PART NO.	DESCRIPTION
8	2560034	34/25 Tooth Count
	2560029	29/30 Tooth Count

#### INPUT SHAFT (5TH DRIVE GEAR)

VIEW #	PART NO.	DESCRIPTION
9	4531818	Mopar 18 Spline 22/37 TC
	4521810	GM 10 Spline 22/37 TC
	4521826	GM 26 Spline 22/37 TC
	4522827	GM 26 Spline 27/31 TC
	4541810	Ford 10 Spline 22/37 TC
	4541826	Ford 26 Spline 22/37 TC

#### INPUT DRIVE GEAR (5TH CLUSTERSHAFT)

VIEW #	PART NO.	DESCRIPTION
10	5551837	22/37 Tooth Count
	5522531	27/31 Tooth Count

#### 6TH GEAR (MAINSHAFT)

VIEW #	PART NO.	DESCRIPTION
11	4112024	24/53 Tooth Count
	4112025	25/52 Tooth Count
	4112026	26/51 Tooth Count
	4112027	27/50 Tooth Count
	4112925	25/34 Tooth Count
	4112919	19/40 Tooth Count

#### 6TH GEAR (CLUSTERSHAFT)

VIEW #	PART NO.	DESCRIPTION
12	5110053	24/53 Tooth Count
	5110052	25/52 Tooth Count
	5110051	26/51 Tooth Count
	5110050	27/50 Tooth Count
	5110934	25/34 Tooth Count
	5110940	19/40 Tooth Count

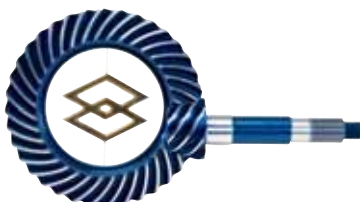



Winners Run RICHMOND!

# Transmissions

## 6-Speed Overdrive - ROD

### Replacement Parts (con't)

VIEW #	PART NO.	DESCRIPTION
13	5271922	Reverse Idler Gear
14	6560037	Reverse Mainshaft
15	5260013	Reverse Clustershaft Gear
16	1304093020	Keys (All)
17	4682AJ	Springs (All) (Not Shown)
18	1304091010	Synchro Brass 1-2 & 3-4
19	6460001	Synchro Brass 5-6
20	6151600	Hub 1-2 & 3-4
21	6160002	Hub 5-6
22	1304089006	Slider 1-2 & 3-4
23	6520000	Slider 5-6
24	6591600	Synchro Assem. 1-2 & 3-4
25	6560001	Synchro Assem. 5-6
26	1304096002	Shift Fork 1-2 & 3-4
27	6760000	Shift Fork 5-6
28	T-1024	Shift Fork, Reverse
29	6660001	Shift Arm, Reverse
30	6692012	Shift Arm 1-2
31	6655034	Shift Arm 3-4
32	6660050	Shift Arm 5-6
33	7855112	Input I.D. Bearing
34	7855716	Center Cluster Bearing
35	7855306	Front Cluster Bearing
35A	7855606	Rear Cluster Bearing
36	1000130010	Front & Rear Mainshaft Bearing
37	7871030	Rev. Idler Gear Bearing Assem.
38	7871052	2nd & 3rd Gear Bearing Assem. (Not Shown)
39	7871142	1st Gear Bearing Assem. (Not Shown)
40	7899142	4th Gear Bearing (Not Shown)
41	7880046	6th Gear Bearing (Not Shown)
42	8195086	Bearing Retainer Gasket (All)
43	8225750	Input Seal, Ford & Mopar
	8245625	Input Seal, AMC
44	103565	Taper Pin
45	7168113	Maincase (2) Halves
46	7226000	Tailhousing, GM
	7226001	Tailhousing, GM T-5 Repl. Version
	7246000	Tailhousing, Ford & Mopar
	7246001	Tailhousing, Ford Mustang T-5 Repl.
	7276000	Tailhousing, Corvette 4+3 Repl.
47	7360000	Mid-Plate
48	7561004	Mainshaft, GM
	7546101	Mainshaft, Ford, Mopar & Corvette 4+3 Repl. & GM T-5 Repl.

VIEW #	PART NO.	DESCRIPTION
49	7660005	Clustershaft (All)
50	7760001	Rev. Idler Shaft
51	8358113	Flanged Sleeve, 6th Gear
52	8255132	Tailhousing Seal
53	8358112	Shift Arm Bushings 1-2, 3-4 & 5-6
54	1000127050	Tailhousing Bushing
55	1304110002	Speedo Gear (All)
56	8635307	Front Bearing Retainer, Mopar
	8622911	Front Bearing Retainer, GM
	8625920	Front Bearing Retainer, GM Truck
	8644033	Front Bearing Retainer, Ford
	8644035	Front Bearing Retainer, Ford 78-83 1 1/16 - 10 Input
57	6960000	Detent Kit
58	8060000	Small Parts Kit
59	8260000	Case Plug Kit
60	9060000	Fastener Kit
61	8180050	Tailhousing Gasket
62	8260001	Shifter Arm Seal Kit
63	8358114	Flanged Sleeve, Input (Not Shown)
64	8060009	Snap Ring, 5/6 Hub

### ADDITIONAL ITEMS NOT SHOWN

PART NO.	DESCRIPTION
5980004	Reverse Back-Up Light Switch
5960000	Reverse Back-Up Switch Wire Harness
6360005-21	Ford/GM Speedo Adaptor Kit
6360001	Ford Mustang Crossmember (T-5 replacement only)
6360002	Ford Mustang Crossmember Spacer (used with above)
6360000	GM "F" Body Crossmember (for 6 speed replacement of T-5 transmission only)
HR-6000	"Long" 6 Speed Shifter (all except GM T-5 replacement and Corvette 4+3 replacement)
HR-6002	"Long" 6 Speed Shifter (GM T-5 replacement only)
HR-6003	"Long" 6 Speed Shifter (Corvette 4+3 replacement only)
9260000	Corvette Console Shift Emblem (1968-1976)
9260001	Corvette Console Shift Emblem (1977-1981)
9260002	Corvette "Richmond Over Drive" Console Emblem (1984-1988)
8460000	Speedo Ext. Cable (T-5 replacement)
Sy-1310	Slip Yolk Turbo 400
Sy-1330	Slip Yolk Turbo 400
6-SP 760003P	Breather
8260003-1	Vent



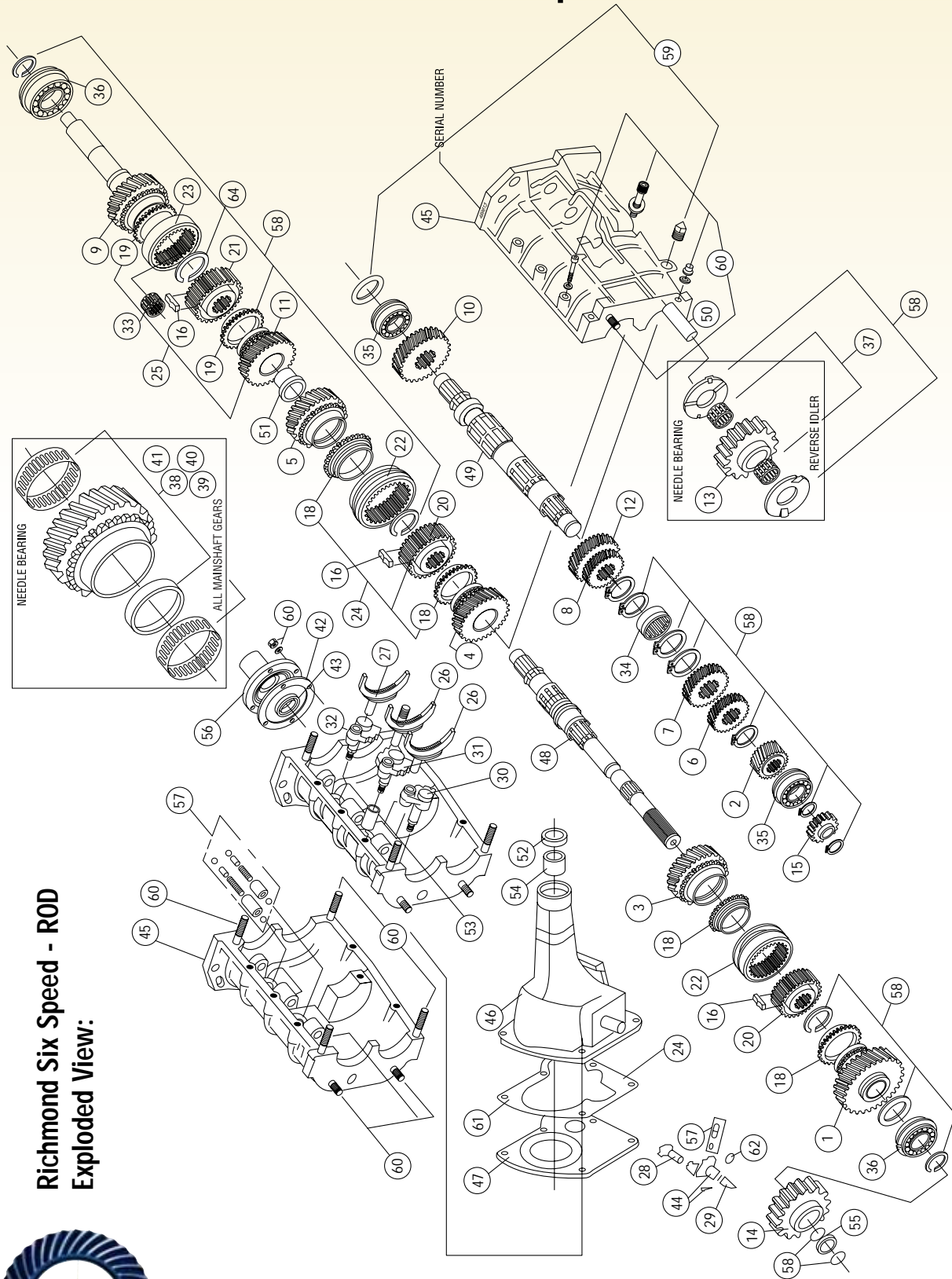

Richmond Six Speed - ROD  
Exploded View:



Always in stock at your local RICHMOND distributor

Phone: 864-843-9231 • Fax: 864-843-2964 • [www.richmondgear.com](http://www.richmondgear.com)