

Dimensions, Input Sets & Selection Guide

The Richmond Street Five Speed transmission delivers the ultimate blend of performance and economy. Utilization of four extra low gear ratios provide dramatic improvements in acceleration, while a 1:1 fifth gear allows maintenance of original fuel economy.

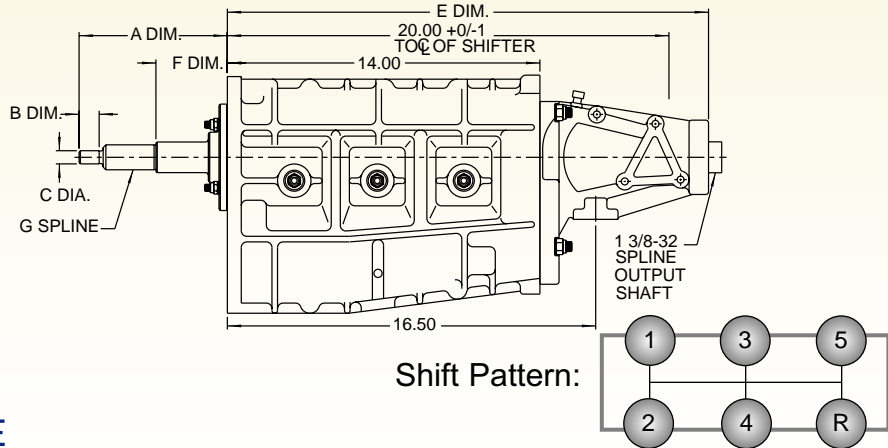
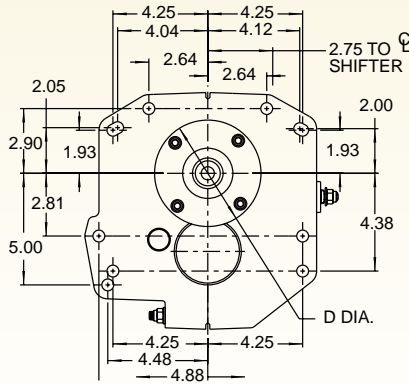
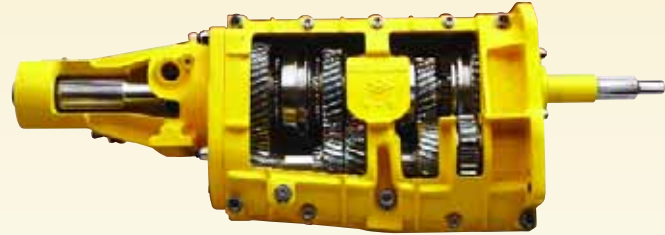

MOUNTING SPECIFICATION GUIDE

APPLICATION	PART NO.	A DIM.	B DIM.	C DIA.	D DIA.	E DIM.	F DIM.	G SPLINE
Ford	7041710	6.49*	1.14*	.668	4.849	24.00	3.83	1-1/8 - 26
Ford**	7041711	7.18	1.14	.668	4.849	24.00	4.37	1-1/16 - 10
GM	7021710	6.66	1.06	.590	4.683	21.57	3.22	1-1/8 - 26
GM	7021711	6.66	1.06	.590	4.683	21.57	3.22	1-1/8 - 10
GM Truck	7061710	6.66	1.06	.590	5.124	21.57	3.22	1-1/8 - 10
GM Truck	7061726	6.66	1.06	.590	5.124	21.57	3.22	1-1/8 - 26
Mopar	7031710	8.57	2.54	.748	4.807	24.00	4.28	1-3/16 - 18

* For small block engines. For big block, cut pilot (B Dim.) by .38
 ** '78 - '83 (5.0 L)

TRANSMISSION RATIO SELECTION GUIDE

PART NO.	DESCRIPTION	SPLINE	1ST	2ND	3RD	4TH	5TH	REV.	TORQUE
7021710-A	GM 1-1/8	26	3.28	2.13	1.57	1.24	1.00	4.79	450 FP
7021711-A	GM 1-1/8	10	3.28	2.13	1.57	1.24	1.00	4.79	450 FP
7031710-A	Mopar 1-3/16	18	3.28	2.13	1.57	1.24	1.00	4.79	450 FP
7041710-A	Ford 1-1/8	26	3.28	2.13	1.57	1.24	1.00	4.79	450 FP
7041711-A	Ford 1-1/16	10	3.28	2.13	1.57	1.24	1.00	4.79	450 FP
7061726-A	GM Truck 1-1/8	26	3.28	2.13	1.57	1.24	1.00	4.79	450 FP
7061710-A	GM Truck 1-1/8	10	3.28	2.13	1.57	1.24	1.00	4.79	450 FP
Part No. - B			4.06	2.22	1.57	1.24	1.00	4.79	400 FP
Part No. - C			4.41	2.22	1.57	1.24	1.00	4.79	373 FP

Center Distance	3.50 Inches
Oil Capacity	2 U.S Quarts
Approximate Dry Weight	95 lbs.
Case & Extension Housing	Aluminum
Controls	Side Lever

INPUT SETS

	SPLINE	22T/37T INPUT/CLUSTER
GM 1-1/8"	26	4521826 / 5551837
GM 1-1/8"	10	4521810 / 5551837
Ford 1-1/8"	26	4541826 / 5551837
Ford 1-1/16"	10	4541810 / 5551837
Mopar 1-3/16"	18	4531818 / 5551837





Winners Run RICHMOND!

Transmissions

Street 5-Speed

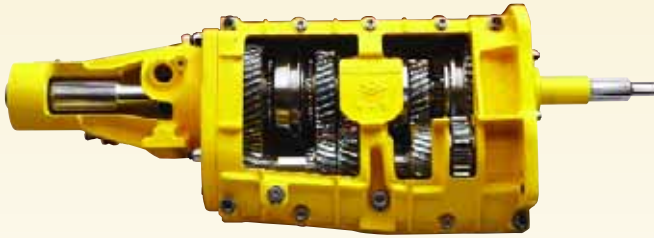

Replacement Parts

For view number see exploded view on page 56.

VIEW #	PART NO.	DESCRIPTION	VIEW #	PART NO.	DESCRIPTION
1	1071839	1st Gear Mainshaft 3.28 A Ratio	26	7571532	Mainshaft GM
	1071841	1st Gear Mainshaft 4.06 B Ratio		7572203	4WD Main Shaft
	1071842	1st Gear Mainshaft 4.41 C Ratio	27	7651010	Cluster Shaft
2	1551820	1st Gear Cluster 3.28 A Ratio	28	7774115	Shaft Reverse Idler
	1551517	1st Gear Cluster 4.06 B Ratio	29	7855112	Input ID Bearing
	1551516	1st Gear Cluster 4.41 C Ratio	30	7855716	Center Cluster Bearing
3	2371833	2nd Gear Mainshaft	31	7855306	Rear Cluster Bearing
4	2371528	3rd Gear Mainshaft	31A	7855605	Front Cluster Bearing
5	2471825	4th Gear Mainshaft	32	1000130010	Rear Output Bearing
6	2551525	2nd Gear Cluster B & C Ratio	33	7871030	Rev. Gear Bearing Assembly
	2551826	2nd Gear Cluster A Ratio	34	7871052	2nd & 3rd Gear Bearing Assembly (Not Shown)
7	2551830	3rd Gear Cluster	35	7871142	1st Gear Bearing Assembly (Not Shown)
8	2551834	4th Gear Cluster	36	7899442	4th Gear Bearing Assembly (Not Shown)
9	4521826	Input 26 Spline GM	37	1000130010	Input Bearing
	4531818	Input 18 Spline Mopar	38	8051500	Small Parts Kit
	4541826	Input 26 Spline Ford	39	8071400	Split Thrust Collar 4th Bearing
	4541810	Input 10 Spline Ford 78-83	40	8195086	Bearing Retainer Gasket (All)
11	5271922	Rev. Idler Gear	41	8225750	Input Seal, GM, Ford, Mopar
10	5551837	5th Gear Cluster	42	8251500	Case Plug Kit
12	6251500	Keys & Springs 5-REV	43	8255132	Extension Housing Seal
13	6291034	Keys & Springs 1-2-3-4	44	T90A108	Shifting Arm Seals (3 req.'d.)(Not Shown)
14	6451500	Synchro Brass 5-REV	45	8358112	Shift Arm Bushings
15	1304091002	Synchro Brass 1-2 & 3-4	46	1000127050	Extension Housing Bushing
16	6571837	5-REV Synchro Assembly		8380008	Extension Housing Bushing 9/85 & Newer
16 Alt.	6591700	5-REV Synchro Assy-1 New Bullet Proof	47	1304110002	Speedo Gear (All)
17	6591510	Synchro Assembly 1-2-3-4	48	8624911	Front Bearing Retainer, GM
17 Alt.	6591600	Synchro Assy 1-2-3-4 New Bullet Proof		8625920	Front Bearing Retainer, GM Truck
18	6692012	1-2 Shift Arm		8635307	Front Bearing Retainer, Mopar
19	6655034	3-4 Shift Arm		8644033	Front Bearing Retainer, Ford
20	6691034	5-REV Shift Arm		8644035	Front Bearing Retainer, Ford 78-83
21	6751550	Shift Fork 5-REV	49	9055500	Fastener Kit
22	1304096002	Shift Fork		HN1000	Shifter (Long)
23	6951500	Detent Kit		HN1002	Shifter (Long) 82-90 "F" Body
24	7158113	Main Case (2 Halves)		Sy-1310	Slip Yoke Turbo 400
	7158114	Main Case (2 Halves) 4 WD		Sy-1330	Slip Yoke Turbo 400
25	7221003	Extension Housing GM			
	7241003	Extension Housing Ford & Mopar			
	7252203	4WD Adapter Plate			
26	7541532	Mainshaft Ford & Mopar			



Always in stock at your local RICHMOND distributor



Phone: 864-843-9231 • Fax: 864-843-2964 • www.richmondgear.com

Street 5-Speed Exploded View

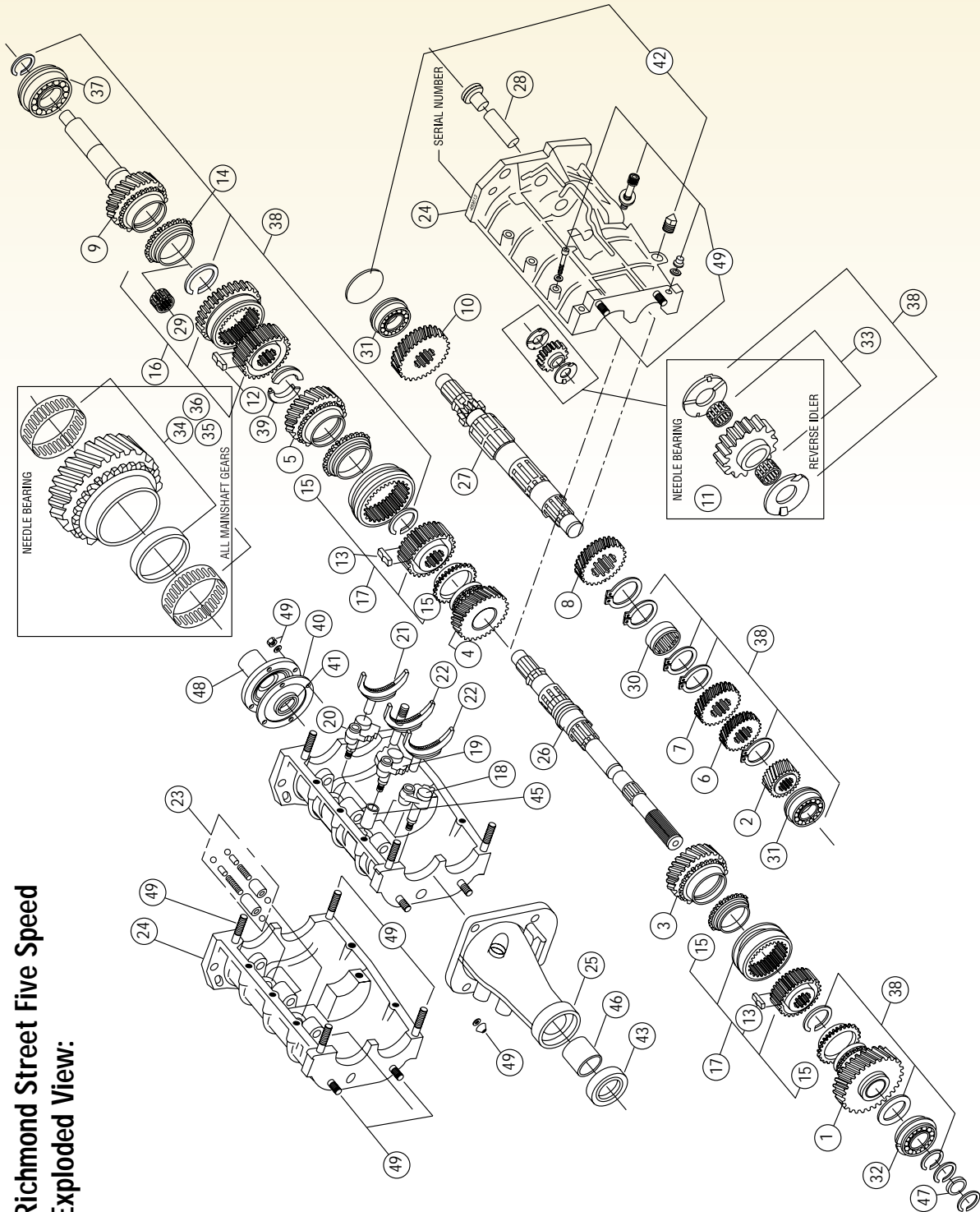

Richmond Street Five Speed
Exploded View:



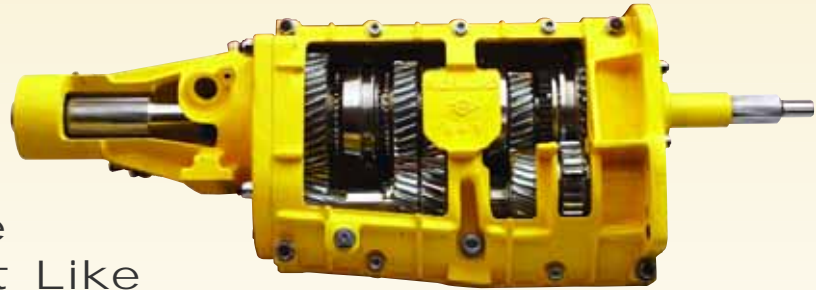

How to Make 5th Gear Act Like an Overdrive

Example:

Muncie close ratio is 2.20 1st gear (multiply by the likely rear end) x 4.56 = 10.03

Assume 27" tire, RPM @ 70 MPH = 3972

With 7021710A 5 Speed ratio is 3.28 1st gear (multiply by the likely rear end x 3.08 = 10.10

Assume 27" tire, RPM @ 70 MPH = 2683

2683/3972 = the same as a .68 overdrive!!

Now what?

1. The Richmond 5 Speed can duplicate the Muncie through first 4 gears if you choose.

Muncie Trans Rear Ratio	VS.	RICHMOND Trans Rear Ratio
1st 2.20 4.56 10.03		1st 3.28 3.08 10.10
2nd 1.64 4.56 7.48		2nd 2.45 3.08 7.55
3rd 1.28 4.56 5.84		3rd 1.99 3.08 6.13
4th 1.00 4.56 4.56		4th 1.52 3.08 4.68

The Richmond 5-Speed matches a Muncie!

NOW! Shift into 5th for an absolutely quiet overdrive.

All overdrives are gears under power in mesh. All gears under power make some noise. The Richmond 5 -Speed is straight through and **dead quiet!**

OR

2. The Richmond 5-Speed can run 5 gears, all tuned to equal energy.

7021710A has 5 gears to shift with equal splits, but in 5th gear it is 68% less RPM than a Muncie.

