



Winners Run RICHMOND!

# Transmissions

## 5-Speed Road Race

### Dimensions



The Richmond Road Race Five Speed transmission is designed for the specific requirements of the road racer. The five speed transmission is made in the U.S.A. by American Craftsmen using the latest CNC machining and in house heat treat. This transmission features NASCAR proven road race style brass and a steel billet front bearing retainer for strength. Available in a wide variety of ratios, this transmission has tremendous torque multiplication and easy serviceability. Fully synchronized for smooth shifting, this five speed meets the challenge of demanding shifting of the road racer!

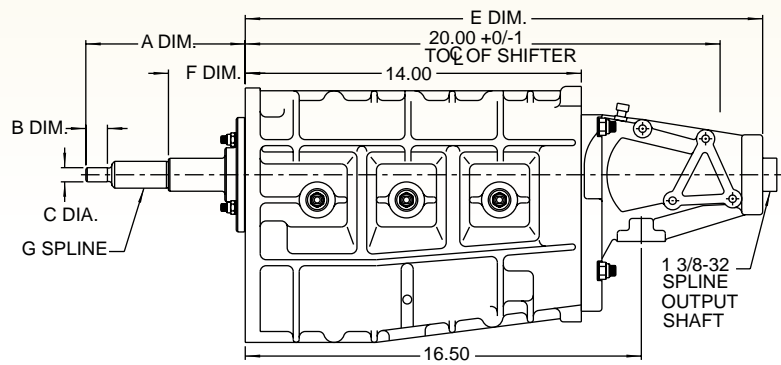
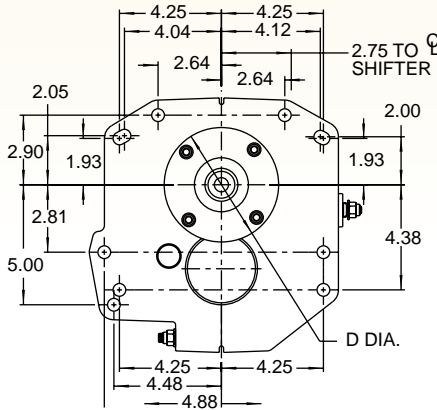

Shift Pattern:

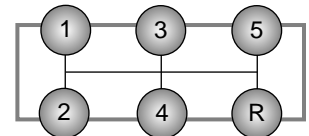

### MOUNTING SPECIFICATION GUIDE

| APPLICATION | PART NO. | A DIM. | B DIM. | C DIA. | D DIA. | E DIM. | F DIM. | G SPLINE    |
|-------------|----------|--------|--------|--------|--------|--------|--------|-------------|
| Ford        | 7042726  | 6.49*  | 1.14*  | .668   | 4.849  | 24.00  | 3.83   | 1-1/8 - 26  |
| Ford**      | 7042710  | 7.18   | 1.14   | .668   | 4.849  | 24.00  | 4.37   | 1-1/16 - 10 |
| GM          | 7022726  | 6.66   | 1.06   | .590   | 4.683  | 21.57  | 3.22   | 1-1/8 - 26  |
| GM          | 7022710  | 6.66   | 1.06   | .590   | 4.683  | 21.57  | 3.22   | 1-1/8 - 10  |
| GM Truck    | 7062710  | 6.66   | 1.06   | .590   | 5.124  | 21.57  | 3.22   | 1-1/8 - 10  |
| GM Truck    | 7062726  | 6.66   | 1.06   | .590   | 5.124  | 21.57  | 3.22   | 1-1/8 - 26  |
| Mopar       | 7032718  | 8.57   | 2.54   | .748   | 4.807  | 24.00  | 4.28   | 1-3/16 - 18 |

\* For small block engines. For big block, cut pilot (B Dim.) by .38

\*\* '78 - '83 (5.0 L)

|                          |              |
|--------------------------|--------------|
| Center Distance          | 3.50 Inches  |
| Oil Capacity             | 2 U.S Quarts |
| Approximate Dry Weight   | 95 lbs.      |
| Case & Extension Housing | Aluminum     |
| Controls                 | Side Lever   |

Use RICHMOND  
Transmission Lube  
Part # TLUBE (pg 126)



Performance Matched For  
WINNERS!



Always in stock at your local RICHMOND distributor



Phone: 864-843-9231 • Fax: 864-843-2964 • www.richmondgear.com



### Selection Guide & Input Sets

#### INPUT SETS

|                           | 22T/37T<br>INPUT/CLUSTER | 27T/31T<br>INPUT/CLUSTER |
|---------------------------|--------------------------|--------------------------|
| GM 1-1/8" - 26 Spline     | 4521826 / 5551837        | 4522827 / 5522531        |
| GM 1-1/8" - 10 Spline     | 4521810 / 5551837        | N / A                    |
| Ford 1-1/8" - 26 Spline   | 4541826 / 5551837        | N / A                    |
| Ford 1-1/16" - 10 Spline  | 4541810 / 5551837        | N / A                    |
| Mopar 1-3/16" - 18 Spline | 4531818 / 5551837        | N / A                    |

#### TRANSMISSION RATIO SELECTION GUIDE

|           |             |           | MASTER DRIVE SET |              | 22/37 | 27/31 |
|-----------|-------------|-----------|------------------|--------------|-------|-------|
|           |             |           | DRIVE RATIO      |              | 1.682 | 1.148 |
| GEAR      | TOOTH COUNT | SET RATIO | MAINSHAFT GEAR   | CLUSTER GEAR | RATIO |       |
| 1st       | 42/16       | 2.625     | 1071842          | 1551516      | 4.41  | 3.01  |
|           | 41/17       | 2.412     | 1071841          | 1551517      | 4.06  | 2.77  |
|           | 39/20       | 1.950     | 1071839          | 1551820      | 3.28  | 2.24  |
|           | 38/21       | 1.810     | 1022838          | 1522821      | 3.04  | 2.08  |
| 2nd & 3rd | 36/22       | 1.636     | 2322836          | 2522822      | 2.75  | 1.88  |
|           | 35/24       | 1.458     | 2322835          | 2522824      | 2.45  | 1.67  |
|           | 33/25       | 1.320     | 2371833          | 2551525      | 2.22  | 1.52  |
|           | 33/26       | 1.269     | 2371833          | 2551826      | 2.13  | 1.46  |
|           | 32/27       | 1.185     | 2322832          | 2522827      | 1.99  | 1.36  |
| 4th       | 28/30       | 0.933     | 2371528          | 2551830      | 1.57  | 1.07  |
|           | 25/34       | 0.735     | 2471825          | 2551834      | 1.24  | 0.84  |
|           | 28/31       | 0.903     | 2422828          | 2522831      | 1.52  | 1.04  |
| 5th       | 30/29       | 1.034     | 2422830          | 2522829      | 1.74  | 1.19  |
|           |             |           |                  |              | 1.00  | 1.00  |



Always in stock at your local RICHMOND distributor



### Replacement Parts

For view number see exploded view on page 61.

#### 1ST GEAR (MAINSHAFT)

| VIEW # | PART NO. | DESCRIPTION       |
|--------|----------|-------------------|
| 1      | 1071842  | 42/16 Tooth Count |
|        | 1071841  | 41/17 Tooth Count |
|        | 1071839  | 39/20 Tooth Count |
|        | 1022838  | 38/21 Tooth Count |

#### 1ST GEAR (CLUSTERSHAFT)

| VIEW # | PART NO. | DESCRIPTION       |
|--------|----------|-------------------|
| 2      | 1551516  | 42/16 Tooth Count |
|        | 1551517  | 41/17 Tooth Count |
|        | 1551820  | 39/20 Tooth Count |
|        | 1522821  | 38/21 Tooth Count |

#### 2ND & 3RD GEAR (MAINSHAFT)

| VIEW # | PART NO. | DESCRIPTION       |
|--------|----------|-------------------|
| 3 & 4  | 2322836  | 36/22 Tooth Count |
|        | 2322835  | 35/24 Tooth Count |
|        | 2371833  | 33/25 Tooth Count |
|        | 2371833  | 33/26 Tooth Count |
|        | 2322832  | 32/27 Tooth Count |
|        | 2371528  | 28/30 Tooth Count |

#### 2ND & 3RD GEAR (CLUSTERSHAFT)

| VIEW # | PART NO. | DESCRIPTION       |
|--------|----------|-------------------|
| 6 & 7  | 2522822  | 36/22 Tooth Count |
|        | 2522824  | 35/24 Tooth Count |
|        | 2551525  | 33/25 Tooth Count |
|        | 2551826  | 33/26 Tooth Count |
|        | 2522827  | 32/27 Tooth Count |
|        | 2551830  | 28/30 Tooth Count |

#### 4TH GEAR (MAINSHAFT)

| VIEW # | PART NO. | DESCRIPTION       |
|--------|----------|-------------------|
| 5      | 2471825  | 25/34 Tooth Count |
|        | 2422828  | 28/31 Tooth Count |
|        | 2422830  | 30/29 Tooth Count |

#### 4TH GEAR (CLUSTERSHAFT)

| VIEW # | PART NO. | DESCRIPTION       |
|--------|----------|-------------------|
| 8      | 2551834  | 25/34 Tooth Count |
|        | 2522831  | 28/31 Tooth Count |
|        | 2522829  | 30/29 Tooth Count |

#### INPUT SHAFT (5TH DRIVE GEAR)

| VIEW # | PART NO. | DESCRIPTION                          |
|--------|----------|--------------------------------------|
| 9      | 4521826  | 22/37 T/C GM 1-1/8" 26 Spline        |
|        | 4522827  | 27/31 T/C GM 1-1/8" 26 Spline        |
|        | 4521810  | 22/37 T/C GM 1-1/8" 10 Spline        |
|        | 4541826  | 22/37 T/C Ford 1-1/8" 26 Spline      |
|        | 4541627  | 27/31 T/C Ford 1-1/8" 26 Spline      |
|        | 4541810  | 22/37 T/C Ford 1-1/16" 10 Spline     |
|        | 4531818  | 22/37 T/C Mopar<br>1-3/16" 18 Spline |

#### INPUT GEAR (5TH CLUSTERSHAFT)

| VIEW # | PART NO. | DESCRIPTION       |
|--------|----------|-------------------|
| 10     | 5551837  | 22/37 Tooth Count |
|        | 5522531  | 27/31 Tooth Count |



### Replacement Parts (con't)

| VIEW # | PART NO.   | DESCRIPTION                    |
|--------|------------|--------------------------------|
| 11     | 5271922    | Rev. Idler Gear                |
| 12     | 6251500    | Keys & Springs 5-REV           |
| 13     | 1304093020 | Keys 1-2-3-4                   |
| 14     | 4682AJ     | Spring 1-2 & 3-4 ((Not Shown)) |
| 15     | 1304091010 | Synchro Brass (All)            |
| 16     | 6591700    | 5-REV Synchro Assy.-1          |
| 17     | 6591600    | Synchro Assy. 1-2-3-4          |
| 18     | 6692012    | 1-2 Shift Arm                  |
| 19     | 6655034    | 3-4 Shift Arm                  |
| 20     | 6691034    | 5-REV Shift Arm                |
| 21     | 6751550    | Shift Fork 5-REV               |
| 22     | 1304096002 | Shift Fork                     |
| 23     | 6951500    | Detent Kit                     |
| 24     | 7158113    | Main Case (2 Halves)           |
|        | 7158114    | Main Case (2 Halves) 4 WD      |
| 25     | 7221003    | Extension Housing GM           |
|        | 7241003    | Extension Housing Ford & Mopar |
|        | 7252203    | 4 WD Adapter Plate             |

| VIEW# | PART NO.   | DESCRIPTION                             |
|-------|------------|---|
| 26    | 7541532    | Mainshaft Ford & Mopar                  |
|       | 7571532    | Mainshaft GM                            |
|       | 7572203    | 4 WD Main Shaft                         |
| 27    | 7651010    | Cluster Shaft                           |
| 28    | 7774115    | Shaft Reverse Idler                     |
| 29    | 7855112    | Input ID Bearing                        |
| 30    | 7855716    | Center Cluster Bearing                  |
| 31    | 7855306    | Rear Cluster Bearing                    |
| 31A   | 7855606    | Front Cluster Bearing                   |
| 32    | 1000130010 | Rear Output Bearing                     |
| 33    | 7871030    | Rev. Gear Bearing Assy.                 |
| 34    | 7871052    | 2nd & 3rd Gear Bearing Assy.            |
| 35    | 7871142    | 1st Gear Bearing Assy.                  |
| 36    | 7899422    | 4th Gear Bearing Assy.                  |
| 37    | 1000130010 | Input Bearing                           |
| 38    | 8051500    | Small Parts Kit                         |
| 39    | 8071400    | Split Thrust Collar 4th Bearing         |
| 40    | 8195086    | Bearing Retainer Gasket (All)           |
| 41    | 8225750    | Input Seal, GM, Ford, Mopar             |
| 42    | 8251500    | Case Plug Kit                           |
| 43    | 8255132    | Extension Housing Seal                  |
| 44    | T90A108    | Shifting Arm Seals (3 req'd)(Not Shown) |
| 45    | 8358012    | Shift Arm Bushing                       |
| 46    | 8380008    | Extension Housing Bushing               |
| 47    | 1304110002 | Speedo Gear (All)                       |
| 48    | 8622911    | Front Bearing Retainer, GM              |
|       | 8625920    | Front Bearing Retainer, GM Truck        |
|       | 8635307    | Front Bearing Retainer, Mopar           |
|       | 8644033    | Front Bearing Retainer, Ford            |
|       | 8644035    | Front Bearing Retainer, Ford 78-83      |
| 49    | 9055500    | Fastener Kit                            |
|       | HN1000     | Shifter (Long)                          |
|       | HN1002     | Shifter (Long) 82-90 "F" Body           |
|       | Sy-1310    | Slip Yolk Turbo 400                     |
|       | Sy-1330    | Slip Yolk Turbo 400                     |



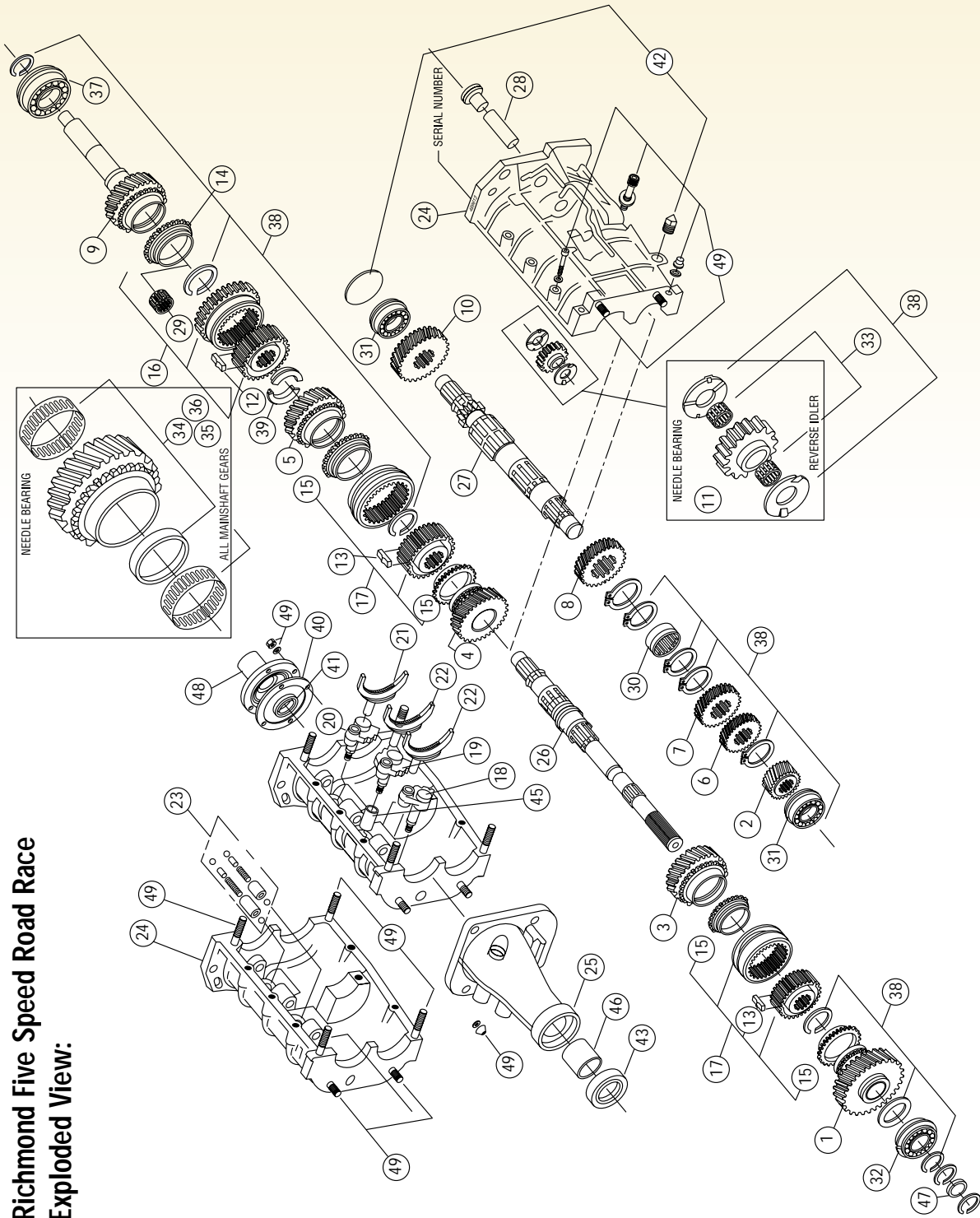

Richmond Five Speed Road Race  
Exploded View:



Always in stock at your local RICHMOND distributor

Phone: 864-843-9231 • Fax: 864-843-2964 • [www.richmondgear.com](http://www.richmondgear.com)